

Electrical Layout
1 : 75

ELECTRICAL LEGEND

-  LIGHT SWITCH
-  DIMMER LIGHT SWITCH
-  CEILING FAN CONTROL
-  STOVE ISOLATOR SWITCH
-  INTERCOM
-  TV POINT
-  SINGLE SOCKET OUTLET
-  DOUBLE SOCKET OUTLET
-  DB BOARD
-  WALL MOUNTED LIGHT FITTING
-  CEILING MOUNTED LIGHT FITTING
-  FLUORESCENT LIGHT FITTING
-  CEILING FAN
-  PENDANT LIGHT FITTING

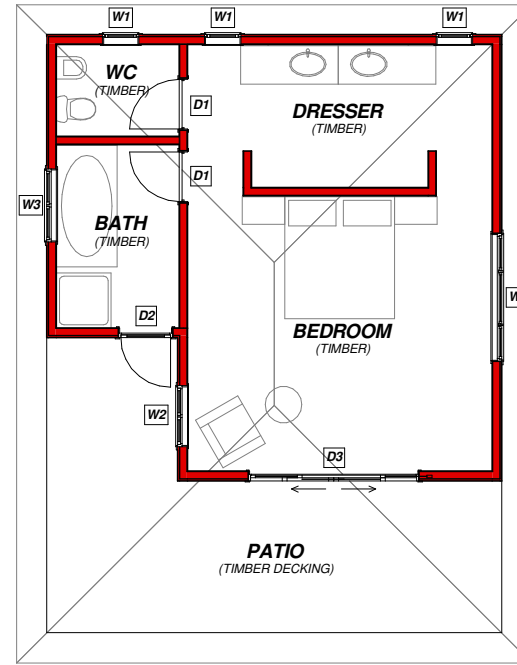

Floor Plan
1 : 75

1. PRESERVATION
ALL STRUCTURAL TIMBERS SHALL BE C.C.A
TREATED AS PER TABLE BELOW.

	HAZARD CLASS SYMBOL					
	H1	H2	H3	H4	H5	H6
FLOOR POSTS						
BEARERS						
FLOOR JOISTS						
WALL PANELS						
ROOF TRUSSES						
EXTERNAL BEAMS						

2. STRESS GRADING
ALL STRUCTURAL TIMBER TO BE SOFTWOOD
TO GRADE 6 OR HIGHER.

3. FIXINGS
ALL STRUCTURAL FIXINGS TO BE GALVANISED
OR RUST PROTECTED.

Rev	Date	Description

The Owner/Client/Contractor shall be responsible for obtaining all necessary permits and approvals from the relevant authorities. The Architect shall be responsible for providing all necessary technical specifications and details. The Contractor shall be responsible for the construction and installation of the works in accordance with the drawings and specifications. The Architect shall be responsible for the design and coordination of the works. The Contractor shall be responsible for the safety and welfare of the workers and the public. The Architect shall be responsible for the quality and finish of the works. The Contractor shall be responsible for the completion and handover of the works. The Architect shall be responsible for the final inspection and certification of the works. The Contractor shall be responsible for the maintenance and repair of the works. The Architect shall be responsible for the overall management of the project. The Contractor shall be responsible for the day-to-day management of the works. The Architect shall be responsible for the design and coordination of the works. The Contractor shall be responsible for the safety and welfare of the workers and the public. The Architect shall be responsible for the quality and finish of the works. The Contractor shall be responsible for the completion and handover of the works. The Architect shall be responsible for the final inspection and certification of the works. The Contractor shall be responsible for the maintenance and repair of the works. The Architect shall be responsible for the overall management of the project. The Contractor shall be responsible for the day-to-day management of the works.

Project:	Nhoxani Holiday Cottages, Mozambique		
Drawing Title:	Bedroom Type 2 - General Layouts		
Project No:	1102	Drawing No:	W100
Scale:	1 : 75	Drawn By:	GW
Date:	07/19/11	Rev:	

